

Dimensions and load capacity

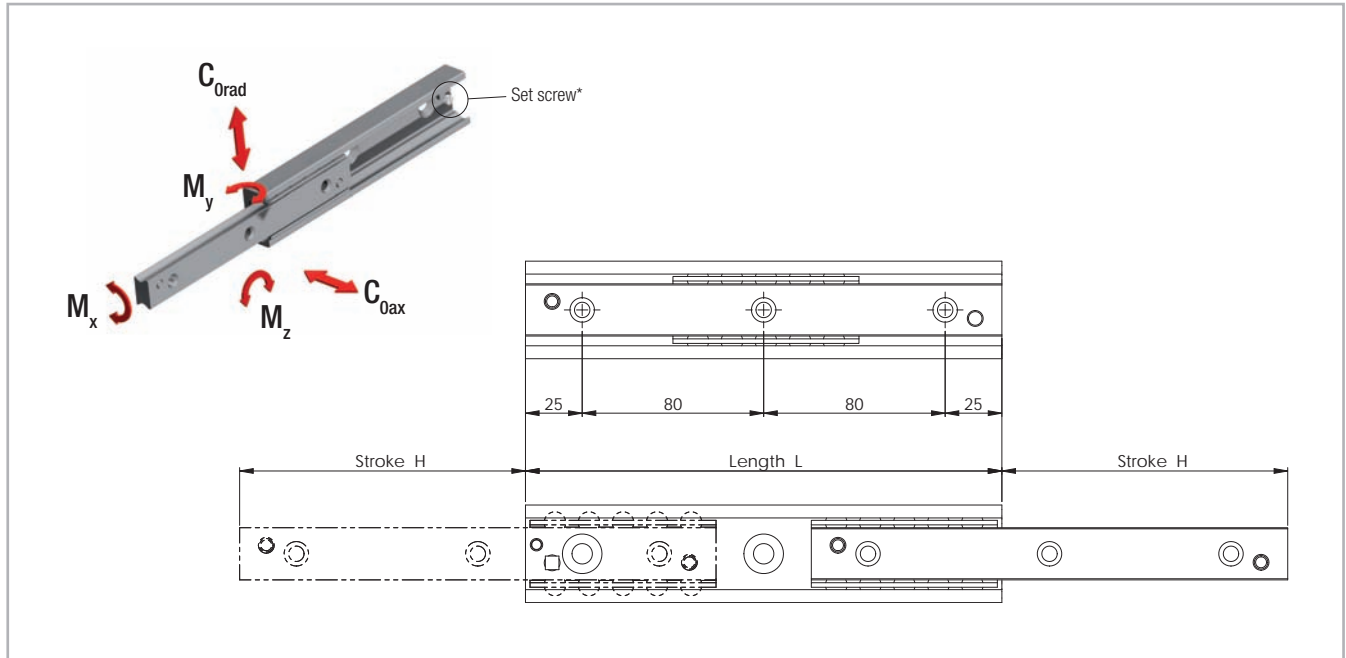

> ASN



* Remove the set screw to reach all the fixing holes. See also assembly instructions on page TR-41f.

Fig. 11

Type	Size	Length L [mm]	Stroke H [mm]	Load capacities and moments*					No. of holes
				C_{0rad} [N]	C_{0ax} [N]	M_x [Nm]	M_y [Nm]	M_z [Nm]	
ASN	22	130	76	313	219	5,7	10	15	2
		210	111	715	501	10,7	36	51	3
		290	154	994	696	14,9	69	99	4
		370	196	1278	895	19	113	162	5
		450	231	1701	1190	24	180	258	6
		530	274	1979	1385	28,2	248	355	7
		610	316	2262	1584	32,3	327	467	8
		690	351	2689	1882	37,3	436	623	9
		770	394	2967	2077	41,5	539	769	10

* The given load capacities and weights apply for a single extension

Tab. 1

Type	Size	Length L [mm]	Stroke H [mm]	Load capacities and moments*					No. of holes
				C_{0rad} [N]	C_{0ax} [N]	M_x [Nm]	M_y [Nm]	M_z [Nm]	
ASN	28	130	74	613	429	15,3	20	28	2
		210	116	1116	781	26,1	57	82	3
		290	148	1934	1354	39,6	132	188	4
		370	190	2445	1711	50,4	213	305	5
		450	232	2955	2069	61,2	314	449	6
		530	274	3466	2426	72	435	621	7
		610	316	3976	2783	82,8	575	821	8
		690	358	4487	3141	93,6	735	1050	9
		770	400	4997	3498	104,4	914	1306	10
		850	433	5828	4080	117,9	1165	1665	11
		930	475	6338	4436	128,7	1389	1984	12
		1010	517	6848	4793	139,5	1631	2330	13
		1090	559	7358	5150	150,3	1894	2705	14
1170	601	7868	5507	161,1	2175	3108	15		
ASN	35	210	127	1065	746	29,4	57	82	3
		290	159	2060	1442	46,9	146	208	4
		370	203	2638	1847	59,9	238	340	5
		450	247	3217	2252	73	354	505	6
		530	279	4282	2997	90,4	543	775	7
		610	323	4858	3401	103,5	711	1015	8
		690	367	5435	3804	116,6	902	1288	9
		770	399	6521	4565	134	1191	1702	10
		850	443	7095	4966	147,1	1435	2050	11
		930	487	7669	5368	160,2	1702	2431	12
		1010	519	8765	6136	177,6	2092	2989	13
		1090	563	9337	6536	190,7	2412	3445	14
		1170	607	9909	6937	203,8	2754	3934	15
		1250	639	11012	7708	221,2	3245	4636	16
		1330	683	11582	8107	234,3	3640	5200	17
1410	727	12153	8507	247,4	4058	5797	18		
1490	759	13260	9282	264,8	4650	6643	19		

* The given load capacities and weights apply for a single extension

Tab. 2

3 Dimensions and load capacity

Type	Size	Length L [mm]	Stroke H [mm]	Load capacities and moments*					No. of holes	
				C_{grad} [N]	C_{Oax} [N]	M_x [Nm]	M_y [Nm]	M_z [Nm]		
ASN	43	210	123	1595	1117	60.6	84	120	3	
		290	158	2872	2010	93.8	201	288	4	
		370	208	3377	2364	115.9	308	440	5	
		450	243	4690	3283	149.2	509	728	6	
		530	278	6039	4227	182.4	762	1088	7	
		610	313	7411	5188	215.6	1064	1521	8	
		690	363	7863	5504	237.8	1294	1849	9	
		770	398	9232	6463	271	1681	2402	10	
		850	433	10615	7431	304.2	2119	3027	11	
		930	483	11054	7738	326.4	2439	3484	12	
		1010	518	12434	8704	359.6	2961	4230	13	
		1090	568	12877	9014	381.8	3337	4767	14	
		1170	603	14254	9978	415	3943	5633	15	
		1250	638	15638	10947	448.2	4599	6571	16	
		1330	688	16075	11252	470.4	5065	7236	17	
		1410	723	17456	12219	503.6	5806	8295	18	
		1490	758	18845	13191	536.8	6598	9425	19	
		1570	793	20238	14167	570.1	7440	10628	20	
		1650	843	20661	14463	592.2	8029	11470	21	
		1730	878	22052	15436	625.5	8956	12794	22	
		1810	928	22479	15736	647.6	9601	13716	23	
		1890	963	23867	16707	680.8	10612	15160	24	
		1970	1013	24298	17009	703	11314	16162	25	
		ASN	63	610	333	10591	7414	474	1553	2219
690	373			12534	8774	547.5	2072	2960	9	
770	413			14489	10142	621	2666	3808	10	
850	453			16452	11516	694.5	3334	4763	11	
930	493			18421	12895	768	4077	5824	12	
1010	533			20395	14277	841.4	4894	6992	13	
1090	573			22373	15661	914.9	5787	8267	14	
1170	613			24354	17048	988.4	6754	9648	15	
1250	653			26337	18436	1061.9	7795	11136	16	
1330	693			28322	19825	1135.4	8912	12731	17	
1410	733			30309	21216	1208.9	10102	14432	18	
1490	773			32297	22608	1282.4	11368	16240	19	
1570	813			34287	24001	1355.9	12708	18155	20	
1650	853			36277	25394	1429.4	14123	20176	21	
1730	893			38268	26788	1502.8	15613	22304	22	
1810	933			40261	28182	1576.3	17177	24539	23	
1890	973			42253	29577	1649.8	18816	26880	24	
1970	1013	44247	30973	1723.3	20530	29328	25			

Tab. 3

* The given load capacities and weights apply for a single extension

> ASN

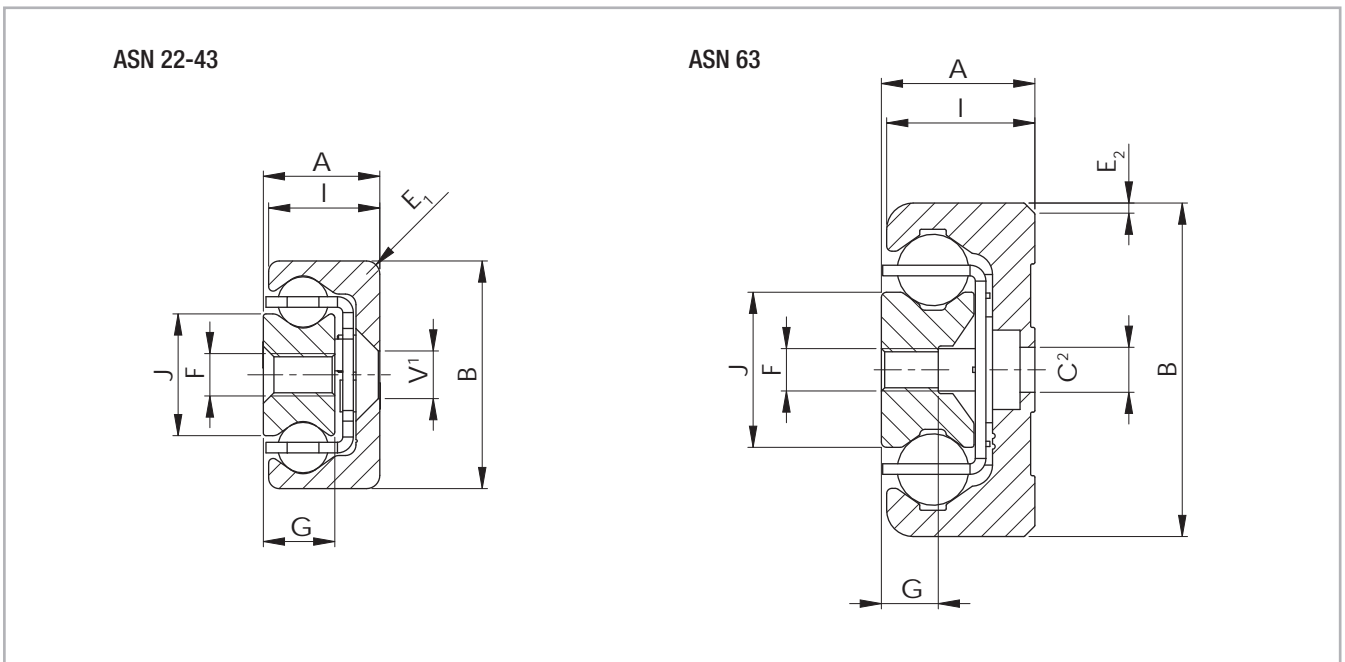

Fig. 12

¹ Fixing holes (V) for countersunk head screws according to DIN 7991

² Fixing holes (C) for socket cap screws according to DIN 7984. Alternative fixing with Torx® screws in special design with low head (on request)

Type	Size	Cross-section										Weight [kg/m]
		A [mm]	B [mm]	I [mm]	J [mm]	G [mm]	E ₁ [mm]	E ₂ [°]	V	C	F	
ASN	22	11	22	10.25	11.3	6.5	3	-	M4	-	M4	1.32
	28	13	28	12.25	15	7.5	1	-	M5	-	M5	2.02
	35	17	35	16	15.8	10	2	-	M6	-	M6	3.05
	43	22	43	21	23	13.5	2.5	-	M8	-	M8	5.25
	63	29	63	28	29.3	10.5	-	2 x 45	-	M8	M8	10.30

Tab. 4